



Advisory #2022-A-009

Subject: Terminal 1 Pier D Service Road Nightly Closures

From: Airport Operations

Contact: Nick Matveev, nick.matveev@gtaa.com, 416-802-9387

Issue Date: February 24, 2022

Due to a section of baggage belt replacement taking place above T1 Pier D Service Road (Figure 1), vehicle access through this section of the tunnel will not be available during the following dates and times:

February 28 – March 11: Sunday to Friday, 22:00 - 05:00

Pedestrian Access will remain available 24/7.

During the closure, Baggage Roadway can be accessed through Entrance by Stand 153 and Exit by Stand 101 (Figure 2). In addition, the contractor will utilize loading zones during closure hours, as per the map.

If you have any questions or concerns regarding this work, please contact Nick Matveev nick.matveev@gtaa.com.

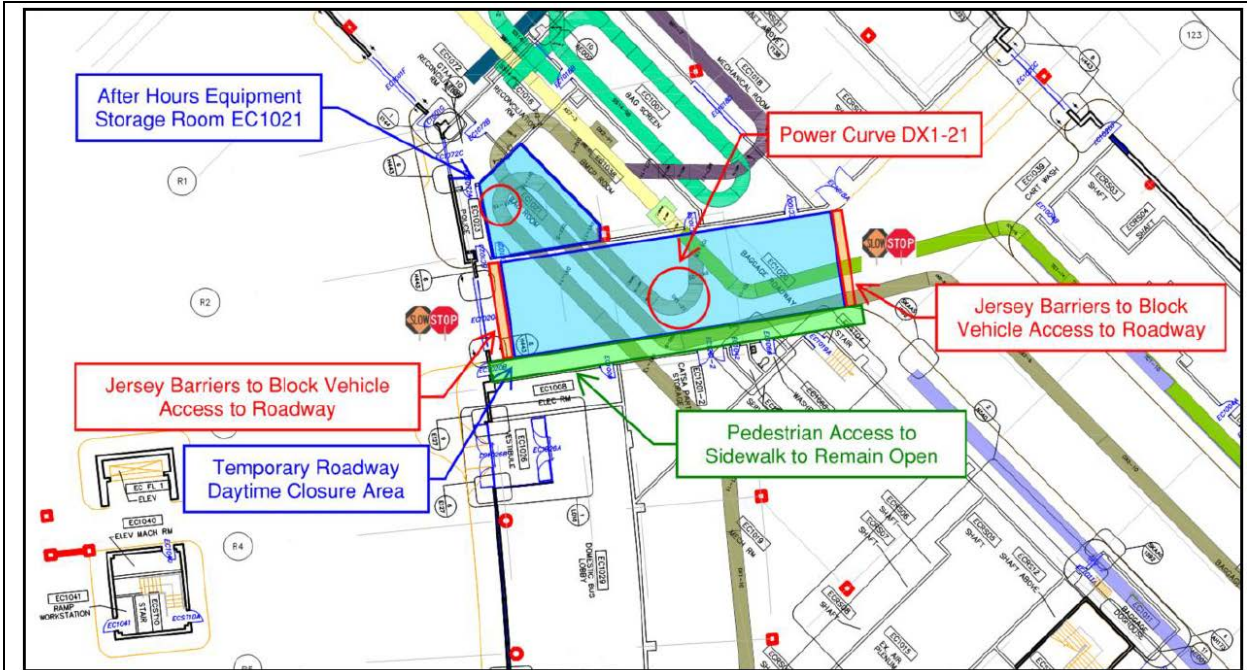

Figure 1 – Power Curve DX1-21 located above the ceiling of tunnel located near Stand 120.

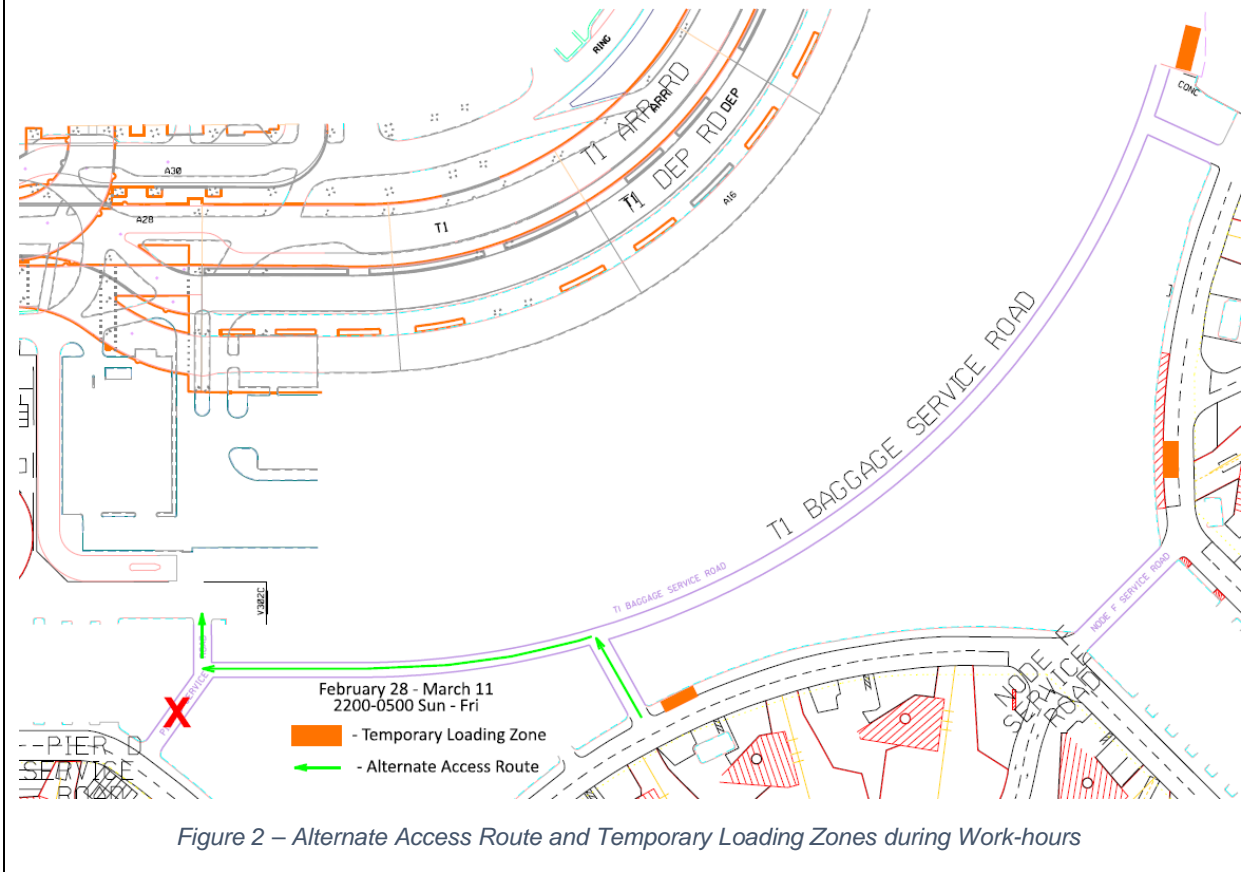

Figure 2 – Alternate Access Route and Temporary Loading Zones during Work-hours