



Advisory # 2022-A-015

Subject: Apron Entrance DR Intersection Closure

From: Airport Operations; Airside Coordination

Contact: Cedric Daros, cedric.daros@gtaa.com, 416-776-5854

Date: 2022-04-07

Apron Entrance DR will be temporarily closed for a period of six (6) weeks commencing on April 11, 2022 @ 0630L. This will facilitate required concrete slab replacement.

As a result of this closure, the following restrictions will be put into place:

- DR Apron Entrance Closed.
- Stand 179 Closed.
- Radius between Taxilane 9 and East/West Taxilane from Stand 178-180A relocated.
- East/West Taxilane between Taxilane 9 and 10 closed.
- Radius between Taxilane 10 and East/West Taxilane restricted to Code C or smaller.
- Aircraft exiting Lane 10 to East/West Taxilane tow-only.
- No Centre-line lighting on Lane 9, Lane 10 and between Apron Entrances AT and DV on the North/South and East/West Taxilane. In the event of Low Visibility Operations, follow-me vehicle operations will be available upon request.
- Tail-of-stand road behind Stand 179 re-routed onto the stand.
- Connecting corridor from Stand 179 crossing Taxilane 9 and 10 Closed.
- Several short-term closures to accommodate line painting.

Please be aware of non-standard aircraft and vehicle movements in the area of Apron Entrance DR intersection and Stand 179.

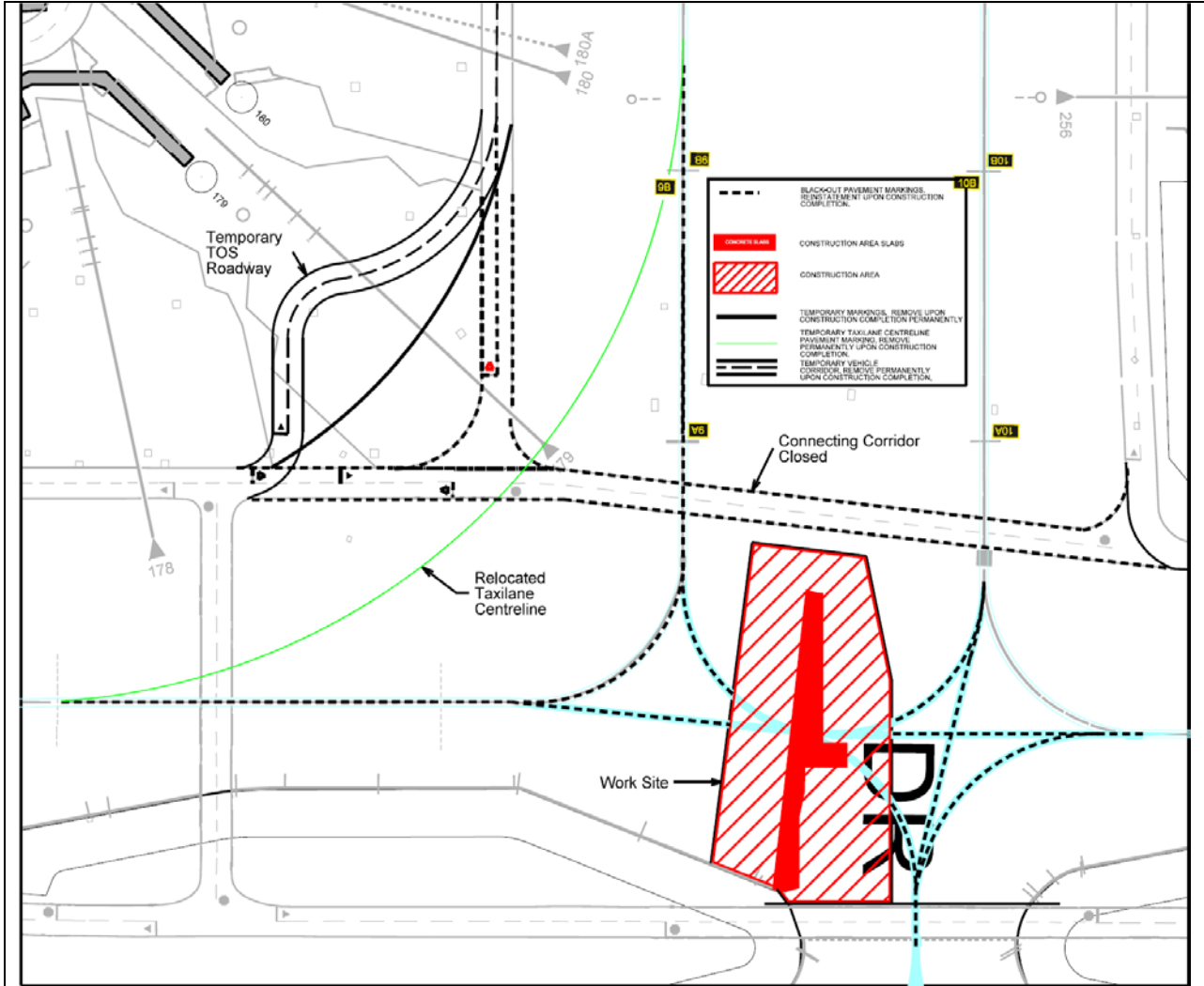

If you have any questions or concerns regarding this work, please contact Cedric Daros using the above contact information.