



Advisory #2023-A-004

Subject: Terminal 3 Baggage Service Road Daily Closures

From: Airport Operations

Contact: Elena Reabchina, elena.reabchina@gtaa.com , 416-801-0815

Issue Date: February 7, 2023

Due to the installation of a new roll up door (K141) within the T3 Baggage Service Road adjacent stand C41 (Figure 1), vehicle access through this area will not be available during the following period:

Wednesday **Feb 8th** & Thursday **Feb 9th** : 07:00 – 18:00 daily.

Operational impact is as follows:

- No access to carousels CI5 & CI6 (CF9 & CF10 in the carousel hall).
- No access IO4 oversize throw-in (Labeled T in the carousel hall).

There is no impact to the outbound assets and pedestrian access will remain at all times.

During the closure, Baggage Roadway can be accessed through the entrance by stand C25 and exit by stand C26 or TX6 (Figure 1 & 2). During the closure, the contractor will be staging equipment within the work area. Outside working hours, the contractor will store equipment within their designated area and the Service Road along with facilities will return to full service.

If you have any questions or concerns regarding this work, please contact Elena Reabchina at elena.reabchina@gtaa.com .

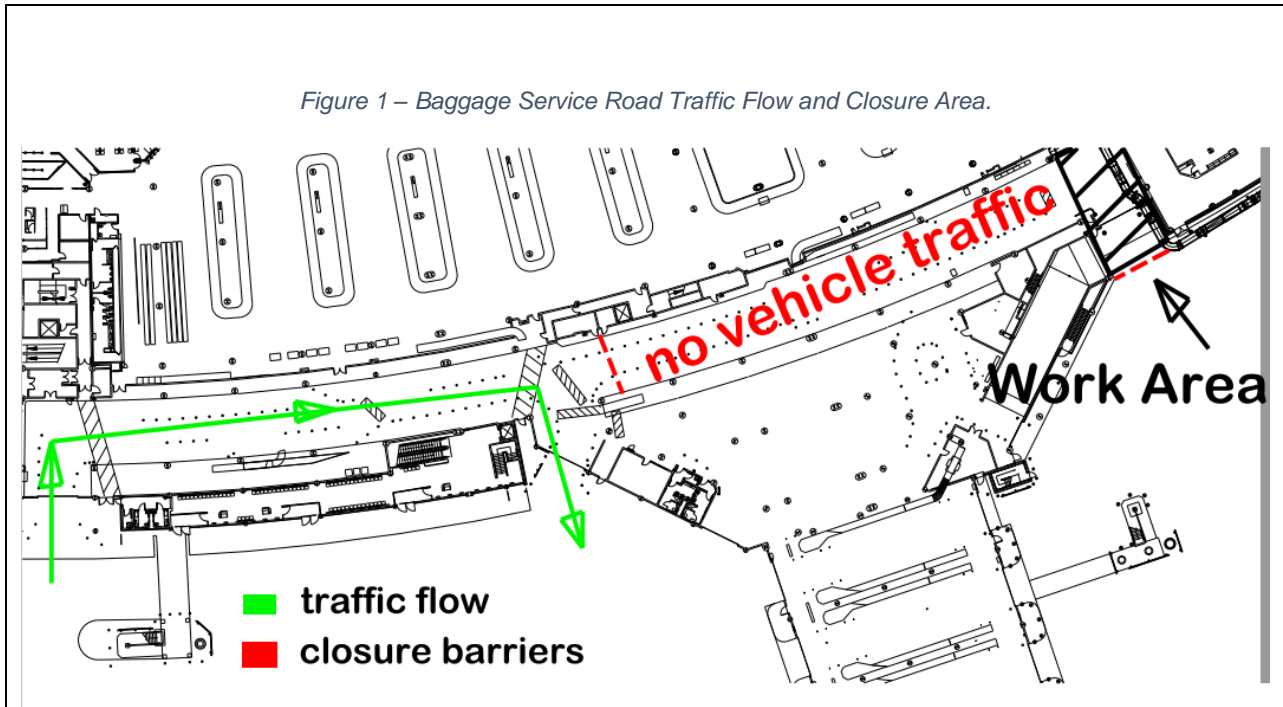

Figure 2 – Baggage Service Road Traffic Flow and Closure Area.

