



**Advisory #2023-A-007**

**Subject: Terminal 1 Pier D Service Road Nightly Closures**

**From:** Airport Operations

**Contact:** Shaneeda Lalani, [Shaneeda.lalani@gtaa.com](mailto:Shaneeda.lalani@gtaa.com), 647-227-7948

**Issue Date:** April 12, 2023

Due to a section of baggage belt replacement taking place above T1 Pier D Service Road (Figure 1), vehicle access through this section of the roadway will not be available during the following dates and times:

**April 16<sup>th</sup> – April 21<sup>st</sup>:** Sunday to Friday, 22:00 - 05:00

Pedestrian Access will remain available 24/7.

During the closure, Baggage Roadway can be accessed through Entrance by Stand 153 and Exit by Stand 101 (Figure 2).

If you have any questions or concerns regarding this work, please contact Shaneeda Lalani [shaneeda.lalani@gtaa.com](mailto:shaneeda.lalani@gtaa.com)

Figure 1 – Power Curve DX1 located above the ceiling of tunnel located near Stand 120.

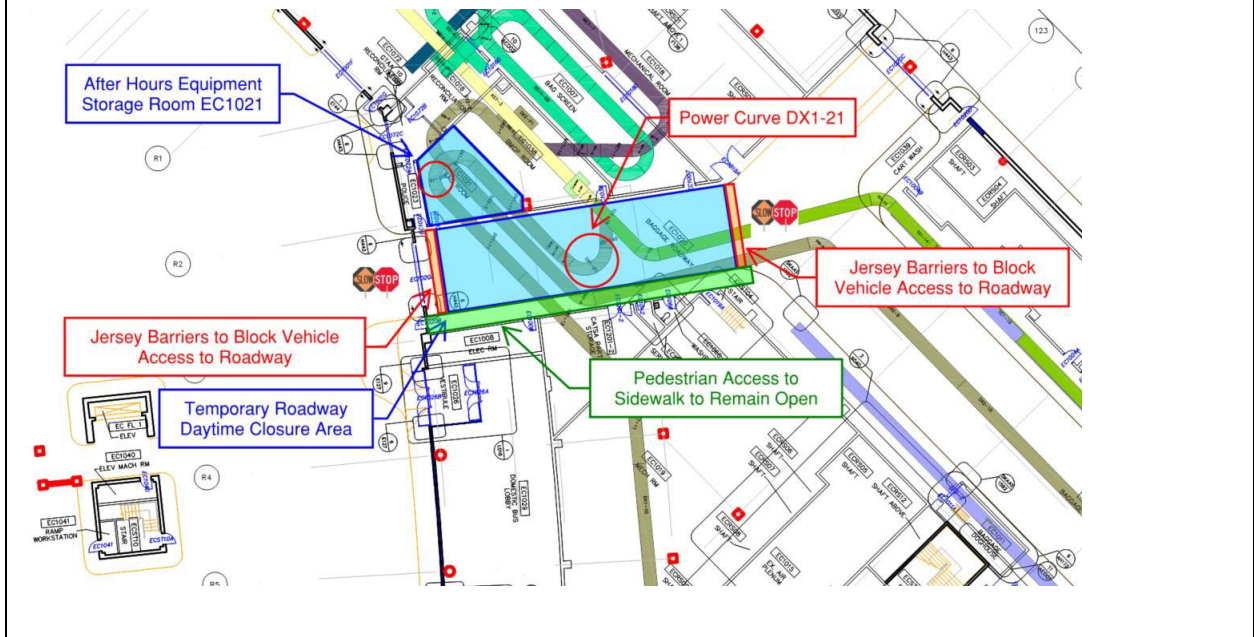

Figure 2 – Alternate Access Route and Temporary Loading Zones during Work-hours

